

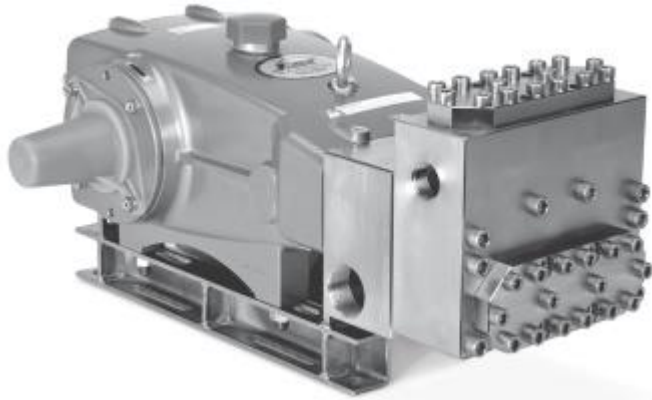

## **Technical specifications and instructions**



### **38 Frame Block-Style Stainless Steel Plunger pump**

**Standard model      *3841***

**Flushed model      *3841K***

### **Specifications (\*)**

#### **Model 3841-3841K**

<b>Flow</b>	174 l/min
<b>Pressure range</b>	7 to 70 bar
<b>RPM</b>	800 RPM

### **Common specifications**

<b>Inlet pressure range</b>	Flooded to 4,9 bar
<b>Bore</b>	45 mm
<b>Stroke</b>	48 mm
<b>Crankcase capacity</b>	4 L
<b>Maximum liquid temperature</b>	60° C
<b>Inlet ports (2)</b>	1-1/2" NPTF
<b>Flushing ports (2)</b>	1/2" NPTF
<b>Discharge ports (2)</b>	1" NPTF
<b>Shaft diameter</b>	35 mm
<b>Weight</b>	63 kg
<b>Dimensions</b>	620 x 460 x 238 mm

(\*) Abnormalities permitted only after consultation and written confirmation from Cat Pumps.

# Exploded View

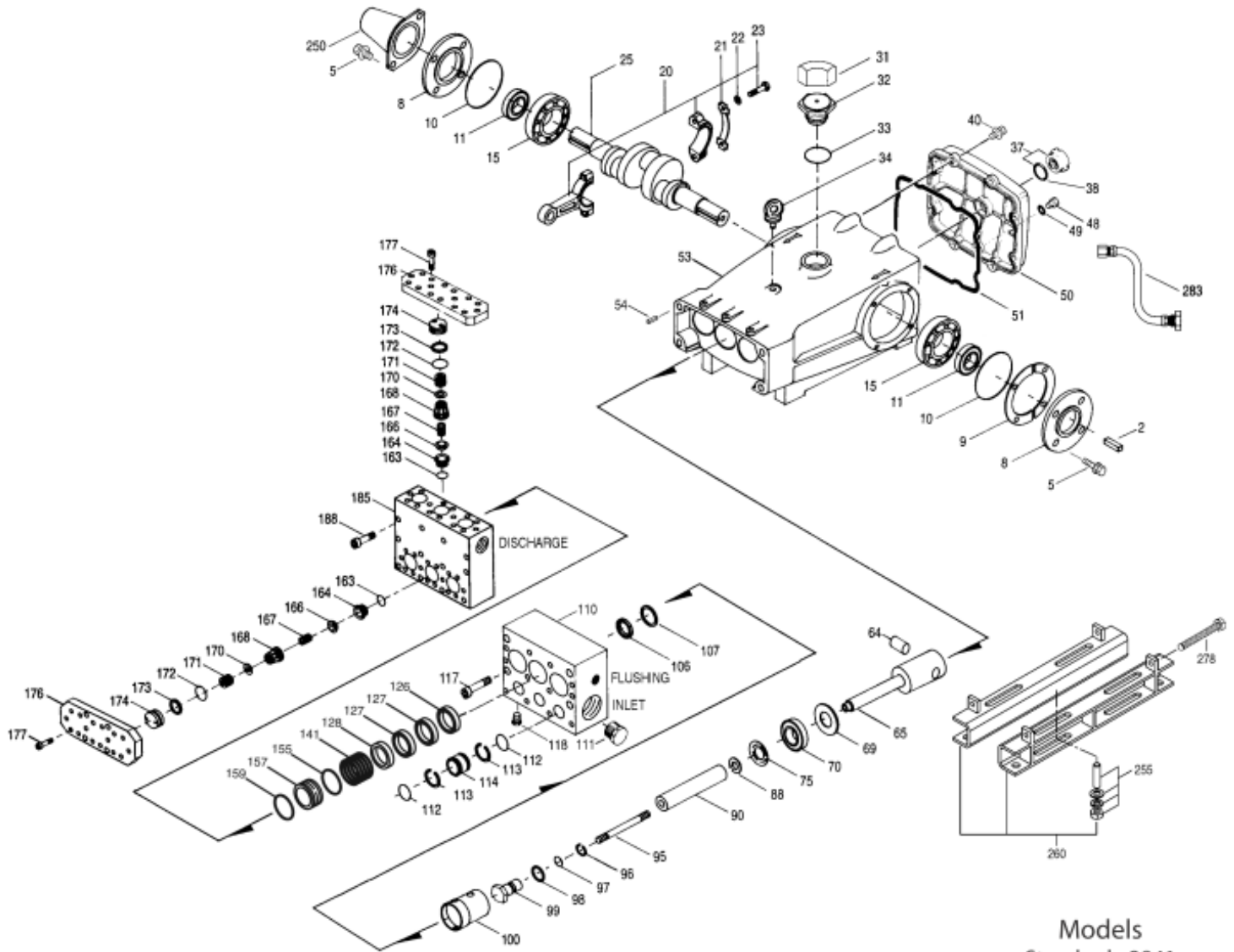

Models  
Standard - 3841  
Flushed - 3841K

# Parts list

Item	Num. 3841	Mat.	Num. 3841K	Mat.	Description	Qty
2	34021	STL	34021	STL	Key (M10x8x70)	1
5	125753	S	125753	S	Screw, HH sems (M8x25)	8
8	44542	AL	44542	AL	Cover, bearing	2
9	815279	FBR	815279	FBR	Shim, split 2-pc	0-2
10	12398	NBR	12398	NBR	O-ring, bearing cover – 70D	2
11	13296	NBR	13296	NBR	Seal, oil, crankshaft	2
15	29326	STL	29326	STL	Bearing, roller	2
20	121467	TNM	121467	TNM	Rod, connecting assy (incl 21,22,23) {10/00}	3
21	126749	STCP R	126749	STCP R	Washer, locking (M10)	3
22	126593	STCP R	126593	STCP R	Washer, flat (M10)	6
23	122045	STZP	122045	STZP	Screw, HH (M10x55)	6
25	29325	FCM	29325	FCM	Crankshaft, dual end (M48)	1
31	828710	PE	828710	PE	Protector, oil cap w/foam gasket	1
32	43211	ABS	43211	ABS	Cap, oil filler	1
33	14177	NBR	14177	NBR	O-ring, oil filler cap – 70D	1
34	126743	STCP R	126743	STCP R	Bolt, eye (M12x1,75) (for lifting pump only)	1
37	92241	-	92241	-	Gauge, oil, bubble w/gasket – 80D	1
38	44428	NBR	44428	NBR	Gasket, flat – 80D	1
40	125753	S	125753	S	Screw, HH sems (M8 x 25)	8
48	25625	STCP	25625	STCP	Plug, drain (1/4" x 19 BSP)	1
49	23170	NBR	23170	NBR	O-ring, drain plug – 70D	1
50	45936	AL	45936	AL	Cover, rear	1
51	16612	NBR	16612	NBR	O-ring, cover – 70D	1
53	44487	AL	44487	AL	Crankcase assy (incl 34,54)	1
55	27488	S	27488	S	Pin, guide	2
64	43864	CM	43864	CM	Pin, crosshead	3
65	45116	STCP	45116	STCP	Rod, plunger	3
69	126587	STZP	126587	STZP	Washer, oil seal	3
70	100488	NBRS	100488	NBRS	Seal, oil, crankcase	3
	44739	FPM	44739	FPM	Seal, oil, crankcase	3
75	43865	S	43865	S	Slinger, barrier	3
88	45676	S	45676	S	Washer, keyhole (M16)	3
90	46806	CC	46806	CC	Plunger (M45x145)	3
95	89778	SS	89778	SS	Stud, plunger retainer (M10x135)	3
96	20189	PTFE	20189	PTFE	Back-up-ring, plunger retainer	3
97	11345	NBR	11345	NBR	O-ring, plunger retainer – 70D	3
	11375	FPM	11375	FPM	O-ring, plunger retainer	3
	# 701490	EPDM	# 701490	EPDM	O-ring, plunger retainer	3
98	44085	SS	44085	SS	Gasket, plunger retainer	3
99	44084	SS	44084	SS	Retainer, plunger (M10)	3
100	44119	PPG	44119	PPG	Retainer, seal	3
106	48384	NBR	48384	NBR	Seal, LPS w/SS-Spg	3
	702013	SFTB	702013	SFTB	Seal, LPS w/SS-Spg	3
	# 46945	EPDM	# 46945	EPDM	Seal, LPS w/S-Spg	3
107	48380	D	48380	D	Spacer, LPS	3
110	<b>701865</b>	<b>SS</b>	-	-	Manifold, inlet, block-style	1
	-	-	<b>701982</b>	<b>SS</b>	Manifold, inlet, block-style, flushed (1/2" NPTF flush)	1
111	701116	SS	701116	SS	Plug, inlet (1-1/2" NPT)	1
112	701632	NBR	701632	NBR	O-ring, inlet spacer	6
	701328	FPM	701328	FPM	O-ring, inlet spacer	6
	# 701973	EPDM	# 701973	EPDM	O-ring, inlet spacer	6
113	701329	PTFE	701329	PTFE	Back-up-ring, inlet spacer	6
114	701327	SS	701327	SS	Spacer, inlet	3
117	701252	SS	701252	SS	Screw HSH (M14x100)	4
118	701077	SS	-	-	Plug (1/4" NPT)	3
126	48383	D	48383	D	Adapter, female	3
127	46813	STGS	46813	STGS	V-packing	6
	703080	SFTB	703080	SFTB	V-packing	6
128	48386	SS	48386	SS	Adapter, male	3
141	49483	SS	45113	SS	Spring, coil, large (see TB 107)	3

155	17784	NBR	17784	NBR	O-ring, spacer – 80D	3
	20138	FPM	20138	FPM	O-ring, spacer – 80D	3
	# 701658	EPDM	# 701658	EPDM	O-ring, spacer – 80D	3
157	49506	SS	49506	SS	Spacer, V-packing (see TB 107)	3
159	17784	NBR	17784	NBR	O-ring, spacer – 80D	3
	20138	FPM	20138	FPM	O-ring, spacer – 80D	3
	# 701658	EPDM	# 701658	EPDM	O-ring, spacer – 80D	3
163	26142	NBR	26142	NBR	O-ring, seat – 80D	6
	14331	FPM	14331	FPM	O-ring, seat – 70D	6
	# 701660	EPDM	# 701660	EPDM	O-ring, seat	6
164	48393	SS	48393	SS	Seat	6
166	44108	SS	44108	SS	Valve	6
167	44109	SS	44109	SS	Spring	6
168	44728	PVDF	44728	PVDF	Retainer, spring	6
170	44729	SS	44729	SS	Washer, spring retainer	6
171	44644	SS	44644	SS	Spring, coil (70 kg), valve plug	6
172	89827	NBR	89827	NBR	O-ring, valve plug – 90D	6
	11747	FPM	11747	FPM	O-ring, valve plug – 90D	6
	# 701494	EPDM	# 701494	EPDM	O-ring, valve plug – 70D	6
173	48364	D	48364	D	Back-up-ring, valve plug	6
174	701278	SS	701278	SS	Plug, valve	6
176	701316	SS	701316	SS	Cover, valve	2
177	87951	S	87951	S	Screw, HSH (M10x30)	32
185	701866	SS	701866	SS	Manifold, discharge, block-style	1
188	701279	S	701279	S	Screw HSH (M12x100)	12
196	701342	SS	701342	SS	Plug, discharge (1" NPT) not shown	1
250	44516	NY	44516	NY	Protector, shaft (w/2 screws, lockwashers, washers) (incl with pump)	1
255	34039	S	34039	S	Assy, direct mount	1
260	92674	STZP R	92674	STZP R	Mount, rail, assy (incl:34018)	1
275	990013	STL	990013	STL	Hub, "B" (35mm w/keyway) (see TB 003)	1
278	80540	ZP	80540	ZP	Screw, HH (M12x100) (rail adjusting screw)	1
283	34314	-	34314	-	Kit, oil drain (3/8"x 48")	1
299	<b>901410</b>	<b>SS</b>	-	-	Head, complete, block-style	1
	-	-	<b>901411</b>	<b>SS</b>	Head, complete, block-style, flushed	1
300	31934	NBR	31934	NBR	Kit, seal (incl. 97,106,112,113,127,155,159)	1
	31961	FPM	31961	FPM	Kit, seal (incl. 97,106,112,113,127,155,159)	1
	# 31923	EPDM	# 31923	EPDM	Kit, seal (incl. 97,106,112,113,127,155,159)	1
310	33835	NBR	33835	NBR	Kit, valve (incl. 163,164,166,167,168,170,172,173)	2
	31262	FPM	31262	FPM	Kit, valve (incl. 163,164,166,167,168,170,172,173)	2
	# 31264	EPDM	# 31264	EPDM	Kit, valve (incl. 163,164,166,167,168,170,172,173)	2
-	819000	F	819000	F	Assembly, crankcase, cast iron conversion	1
370	-	-	<b>990663</b>	-	Assembly, flushing, 19L, 115V, 1.1 Amp, 1/2"NPT	1
390	714500	SS	714500	SS	C.A.T. (Captive Acceleration Tube)	1
391	714506	SS	714506	SS	Adapter (2 per C.A.T.)	2
392	701828	SS	701828	SS	Elbow assy used with adapter assy 714506	1

**Bold print part numbers are unique to a particular pump model. Italics are optional items. { }** Date of latest production change.  
# silicone oil/grease required. R Components comply with RoHS directive. \* Review individual parts in each kit for material identification.  
See 'Tech Bulletins' 002, 003, 024, 035, 036, 041, 043, 053, 074, 077, 083, 095 and 105 for additional information.  
**C.A.T. highly recommended for pressurized inlet, R.O. and industrial applications.**

Material codes: (not part or part number)

ABS	ABS plastic	FPM	Fluorocarbon	SFTB	Special blend PTFE black
AL	Aluminum	NBR	Medium nitrile (Buna-N)	SS	316SS
CC	Ceramic	NBRs	Buna, silicone free	SSZZ	316SS / zamak
CM	Chrome-moly	NY	Nylon	STCP	Steel/chrome plated
D	Acetal	PE	Polyethylene	STGS	Special blend PTFE white
EPDM	Ethylene propylene diene mon.	PPG	Glass filled polypropylene	STL	Steel
F	Cast iron	PTFE	Pure polytetrafluoroethylene	STZP	Steel / zinc plated
FBR	Fiber	PVDF	Polyvinylidene fluoride	TNM	Special high strength
FCM	Forged chrome-moly	S	304SS	ZP	Zinc plated