



## Technical specifications and instructions



### **5CP Plunger Pump**

#### **Standard Model**

**5CP3120**

**5CP3120CSS**

#### **Gearbox Model**

**5CP3120CSSG1**

#### Specifications (\*)

	<b>Model 5CP3120</b>	<b>Model 5CP3120CSS</b>	<b>Model 5CP3120CSSG1</b>
<b>Flow</b>	15 l/min	15 l/min	17 l/min
<b>Pressure range</b>	7 to 245 bar	7 to 245 bar	7 to 245 bar
<b>RPM pump</b>	1420 RPM	1420 RPM	1645 RPM
<b>RPM motor</b>	-	-	3353 RPM
<b>Stroke</b>	18 mm	18 mm	18 mm
<b>Weight</b>	9 kg	9 kg	12 kg
<b>Dimensions</b>	277 x 254 x 147 mm	277 x 218 x 147 mm	284 x 291 x 163 mm

#### Common specifications

<b>Inlet pressure range</b>	-2 to 4 bar
<b>Bore</b>	16 mm
<b>Crankcase capacity</b>	0,50 L
<b>Standard liquid temperature</b>	71° C
<b>Inlet ports (2)</b>	1/2" NPTF
<b>Discharge ports (2)</b>	3/8" NPTF
<b>Shaft diameter</b>	20 mm

(\*) Abnormalities permitted only after consultation and written confirmation from Cat Pumps.

# Exploded View

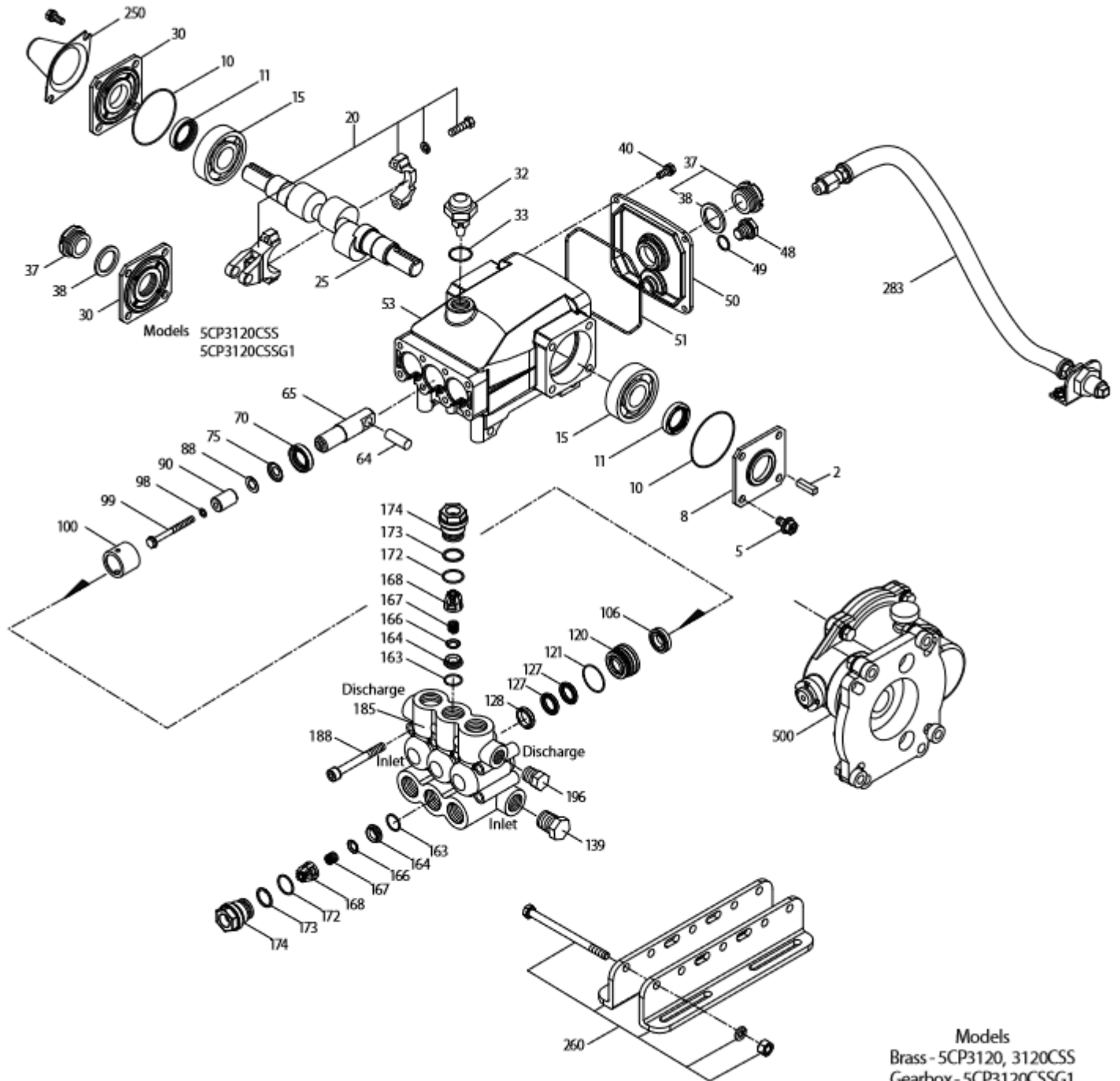

# Parts list

lt.	Num. 5CP3120	Mat.	Num. 5CP3120CSS 5CP3120CSSG1	Mat.	Description	Qt
2	30057	STL	30057	STL	Key (M6x6x25)	1
5	126542	STCP R	126542	STCP R	Screw, HHC sems (M8x16)	8-8-4
8	46910	AL	46910	AL	Cover, bearing	2-1-0
10	14028	NBR	14028	NBR	O-ring, bearing cover – 70D	2-2-1
11	43222	NBR	43222	NBR	Seal, oil, crankshaft – 70D	2-1-0
15	14480	STL	14480	STL	Bearing, ball	2-2-2
20	48742	TNM	48742	TNM	Rod, connecting assy {10/01}	3
25	<b>46928</b>	<b>FCM</b>	-	-	Crankshaft, M18, dual end	1
	-	-	<b>48233</b>	<b>FCM</b>	Crankshaft, M18, single end	1
30	-	-	<b>49776</b>	<b>AL</b>	Cover, bearing blind (after 12/10)	1
	-	-	<b>48224</b>	<b>AL</b>	Cover, bearing blind – 5CP3120G1 (prior to 12/10)	1
32	46798	-	46798	-	Cap, oil filler, domed	1
33	14179	NBR	14179	NBR	O-ring, oil filler cap – 70D	1
37	92241	PC	92241	PC	Gauge, oil, bubble w/gasket – 80D	1-2-2
38	44428	NBR	44428	NBR	Gasket, flat, oil gauge – 80D	1-2-2
40	125824	STCP R	125824	STCP R	Screw, HHC sems (M6x16)	4
48	25625	STCP	25625	STCP	Plug, drain (1/4"x19BSP)	1
49	23170	NBR	23170	NBR	O-ring, drain plug – 70D	1
50	46940	AL	46940	AL	Cover, rear	1
51	14044	NBR	14044	NBR	O-ring, rear cover	1
53	48617	AL	48617	AL	Crankcase	1
64	46746	CM	46746	CM	Pin, crosshead	3
65	48458	BBNP	48458	BBNP	Rod, plunger	3
70	46838	NBR	46838	NBR	Seal, oil, crankcase – 70D	3
75	43900	S	43900	S	Slinger, barrier	3
88	45697	S	45697	S	Washer, keyhole (M18x10)	3
90	46884	CC	46884	CC	Plunger (M16x50)	3
98	46730	NBR	46730	NBR	Washer, seal – 90D	3
	48394	FPM	48394	FPM	Washer, seal – 90D	3
	# 48432	EPDM	# 48432	EPDM	Washer, seal	3
99	+ 48201	SS	+ 48201	SS	Retainer, plunger w/stud (M6)	3
100	46749	PVDF	46749	PVDF	Retainer, seal	3
106	43316	NBR	43316	NBR	Seal, LPS w/S-Spg	3
	106660	FPM	106660	FPM	Seal, LPS w/S-Spg	3
	# 49134	EPDM	# 49134	EPDM	Seal, LPS w/S-Spg	3
	76316	ST2	76316	ST2	Seal, LPS w/S-Spg	3
120	46888	BB	46888	BB	Case, seal (press-in-style)	3
121	13978	NBR	13978	NBR	O-ring, seal case – 70D	3
	14329	FPM	14329	FPM	O-ring, seal case	3
	# 48904	EPDM	# 48904	EPDM	O-ring, seal case	3
127	43319	SNG	43319	SNG	V-packing	6
	46287	HT	46287	HT	V-packing	6
128	46618	NY	46618	NY	Adapter, male	3
139	22179	BBCP	22179	BBCP	Plug, inlet (1/2" NPTM)	1
163	17547	NBR	17547	NBR	O-ring, seat – 85D	6
	11685	FPM	11685	FPM	O-ring, seat – 85D	6
	# 46648	EPDM	# 46648	EPDM	O-ring, seat – 70D	6
164	45790	S	45790	S	Seat	6
166	46429	S	46429	S	Valve	6
167	43750	S	43750	S	Spring	6
168	+ 44565	PVDF	+ 44565	PVDF	Retainer, spring	6
172	17549	NBR	17549	NBR	O-ring, valve plug – 70D	6

	26996	FPM	26996	FPM	O-ring, valve plug – 70D	6
	# 49133	EPDM	# 49133	EPDM	O-ring, valve plug	6
173	48365	D	48365	D	Back-up-ring, valve plug	6
174	45900	BB	45900	BB	Plug, valve	6
185	46886	FBB	46886	FBB	Manifold, head	1
188	126513	STCP R	126513	STCP R	Screw, HSH (M8x70)	8
196	22187	BBCP	22187	BBCP	Plug, discharge (3/8" NPTM)	1
250	<b>118672</b>	<b>STCP</b>	-	-	Protector, shaft	1
255	30243	STZP	30243	STZP	Mount, direct	1
260	30611	STZP R	30611	STZP R	Mount, rail, assy (4.22")	1
	30613	STZP R	30613	STZP R	Mount, rail, assy (5.02")	1
	76513	STZP R	76513	STZP R	Mount, rail, assy (5.52")	1
265	<b>30659</b>	-	-	-	Kit, complete mounting (incl. 30611, 30633, 118672)(belt drive only)	1
283	34334	-	34334	-	Kit, oil drain (3/8" x 24") (see individual data sheet)	1
299	814843	FBB	814843	FBB	Head, complete	1
300	33629	NBR	33629	NBR	Kit, seal (incl. 98, 106, 121, 127, 128) <b>standard</b>	1
	31340	FPM*	31340	FPM*	Kit, seal (incl. 98, 106, 121, 127, 128)	1
	31665	HT	31665	HT	Kit, seal (incl. 98, 106, 121, 127, 128)	1
	# 31730	EPDM*	# 31730	EPDM*	Kit, seal (incl. 98, 106, 121, 127, 128)	1
	76556	STHT	76556	STHT	Kit, seal (incl. 98, 106, 120, 121, 127, 128)	1
310	33060	NBR	33060	NBR	Kit, valve (incl. 163, 164, 166, 167, 168, 172, 173) <b>standard</b>	2
	31345	FPM	31345	FPM	Kit, valve (incl. 163, 164, 166, 167, 168, 172, 173)	2
	# 31735	EPDM	# 31735	EPDM	Kit, valve (incl. 163, 164, 166, 167, 168, 172, 173)	2
500	-	-	8076	-	Gearbox (see individual data sheet)	1

**Bold print numbers are unique to a particular pump model. Italics are optional items. { }** Date of latest production change.

# Silicone oil/grease required. + Production parts are different than repair parts. R Components comply with RoHS directive.

\* Review individual parts in each kit for material code identification.

See 'Tech Bulletins' 024, 036, 043, 053, 060, 061, 064, 073, 074, 078 and 083 for additional information.

Material codes: (not part or part number)

AL	Aluminum	FCM	Forged chrome-moly	SS	316 stainless steel
BB	Brass	FPM	Fluorocarbon	ST2	Special blend PTFE grey
BBCP	Brass / chrome plated	HT	Hi-Temp (EPDM alternative)	STCP	Steel / chrome plated
BBNP	Brass nickel plated	NBR	Medium nitrile (Buna-N)	STHT	Special PTFE High temp
CC	Ceramic	NY	Nylon	STL	Steel
CM	Chrome-moly	PC	Poly Carbonate	STZP	Steel / zinc plated
D	Ecetal	PVDF	Polyvinylidene fluoride	TNM	Special high strength
EPDM	Ethylene propylene diene mon.	S	304 stainless steel		
FBB	Forged brass	SNG	Special blend (Buna)		